

8800-027 PORTER KRESGE ROAD REPAIRS - VEHICLE TRAFFIC PLAN

- █ CONSTRUCTION ZONE: 6/24 - 7/19
- ▬▬▬ ROAD SECTION CLOSED: 6/26 - 7/3
- ▬▬▬ ONE-WAY (SOUTHBOUND) VEHICLE TRAFFIC: 7/4-7/8
- ▬▬▬ PORTER KRESGE ROAD DETOUR: 6/27 - 7/8

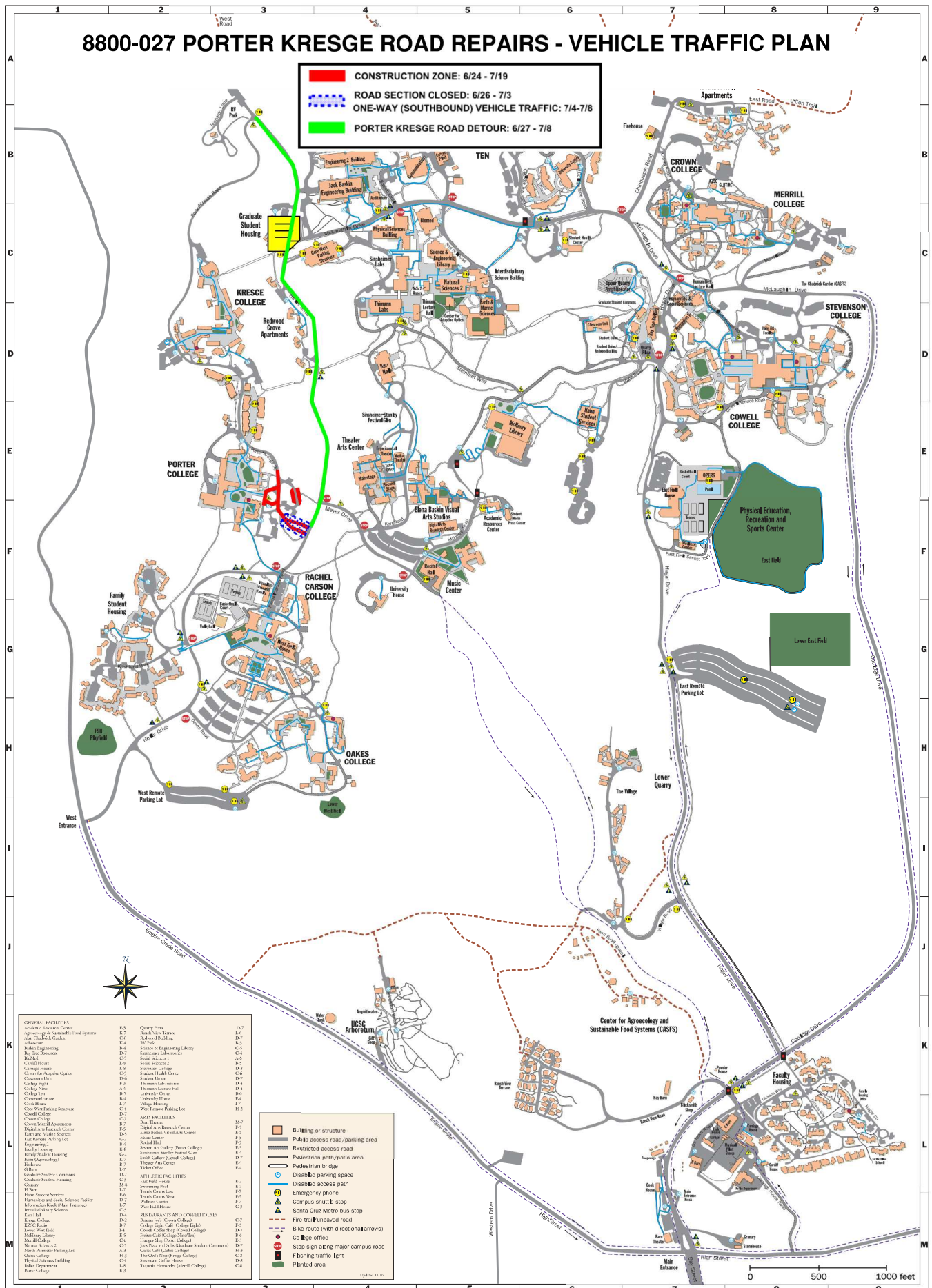

Potholing Plan:
6/26/2019

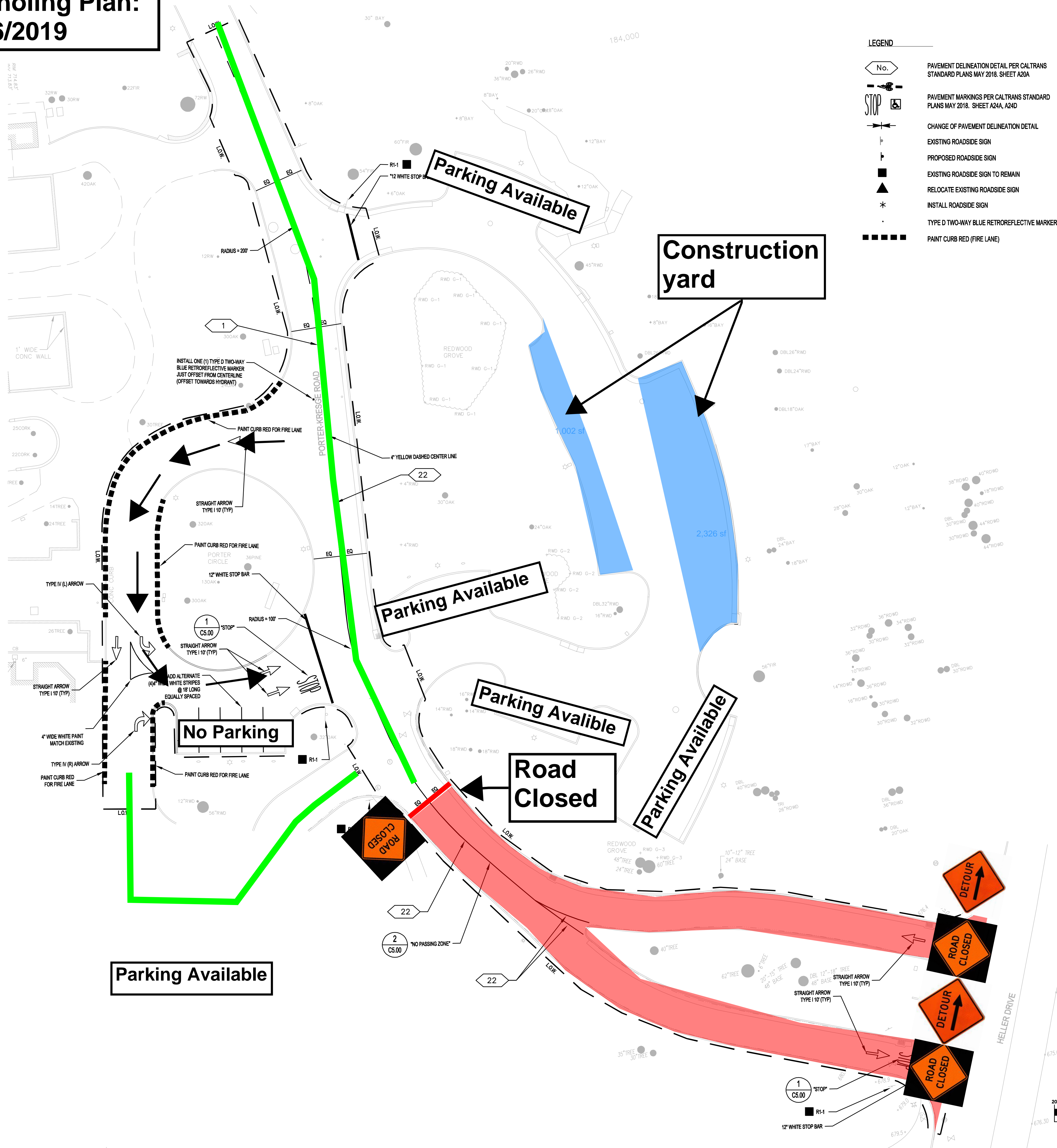

- LEGEND
- No. 1: PAVEMENT DELINEATION DETAIL PER CALTRANS STANDARD PLANS MAY 2018, SHEET A20A
 - STOP: PAVEMENT MARKINGS PER CALTRANS STANDARD PLANS MAY 2018, SHEET A24A, A24D
 - CHANGE OF PAVEMENT DELINEATION DETAIL
 - EXISTING ROADSIDE SIGN
 - PROPOSED ROADSIDE SIGN
 - EXISTING ROADSIDE SIGN TO REMAIN
 - RELOCATE EXISTING ROADSIDE SIGN
 - INSTALL ROADSIDE SIGN
 - TYPE D TWO-WAY BLUE RETROREFLECTIVE MARKER
 - PAINT CURB RED (FIRE LANE)

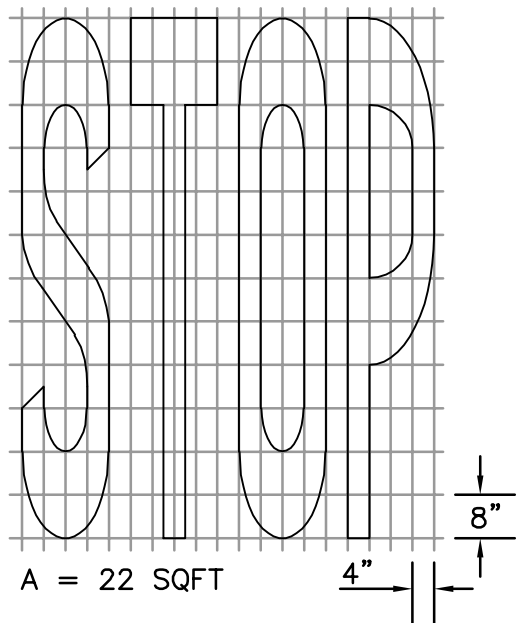

- NOTES:
- ALL PAVEMENT MARKINGS AND SIGNAGE SHALL BE IN ACCORDANCE WITH CALTRANS STANDARDS
 - IF A MESSAGE CONSISTS OF MORE THAN ONE WORD IT MUST READ "UP", I.E. THE FIRST WORD MUST BE NEAREST THE DRIVER.
 - MINOR VARIATIONS IN DIMENSIONS MAY BE ACCEPTED BY THE ENGINEER
 - ALL LETTERING TO BE THERMOPLASTIC PER SPEC SECTION 32 17 23 AND CALTRANS STANDARD SPECIFICATIONS

1. TRAFFIC LETTERING
N.T.S.

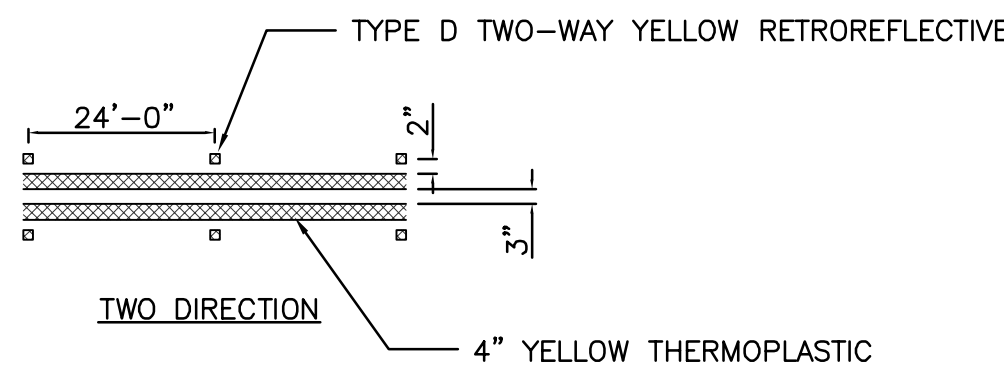

- NOTES:
- NO PASSING ZONE STRIPING PER DETAIL 22 OF CALTRANS 2018 STANDARD PLANS

2. NO PASSING ZONES-TWO DIRECTION
N.T.S.

Legend:
Work Zone

: Two Way Traffic

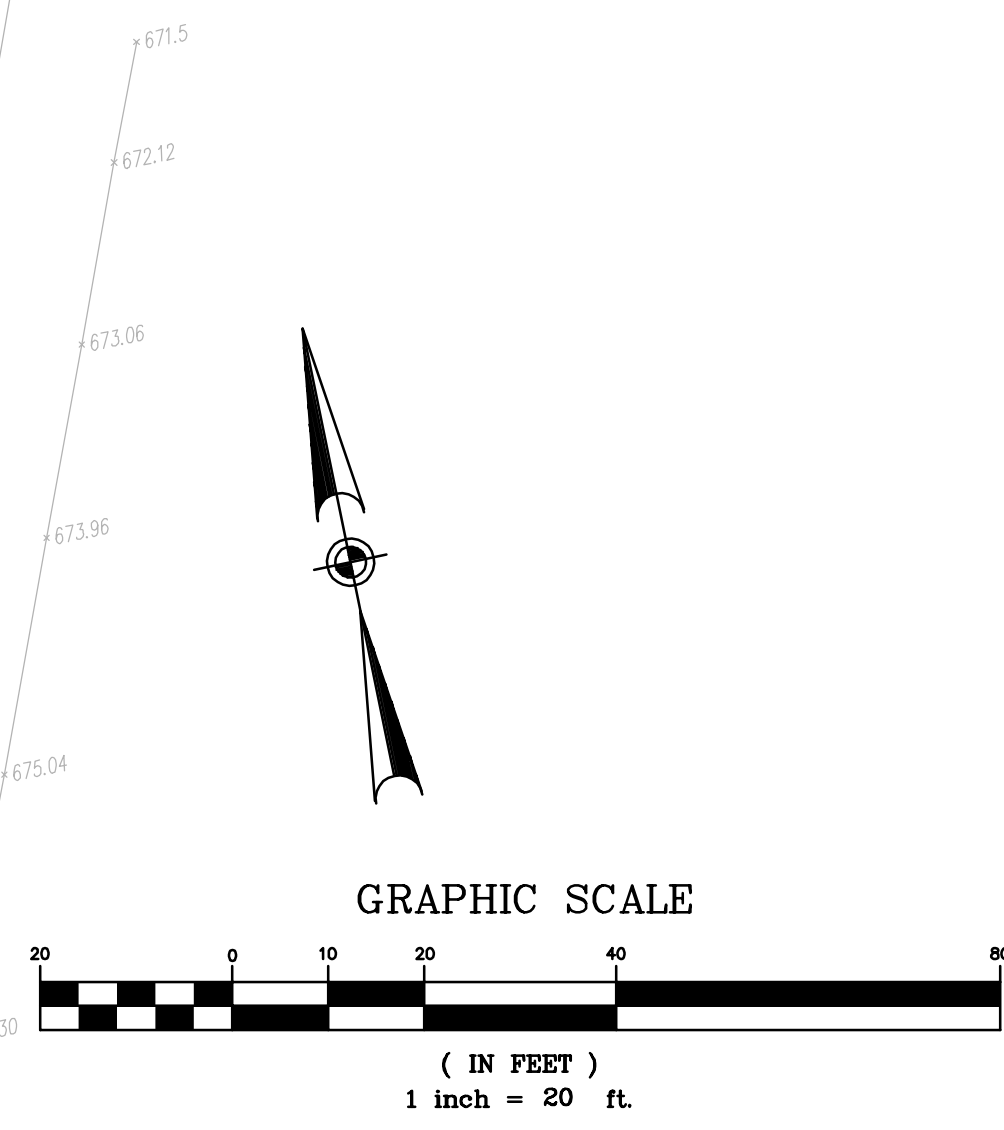

4570 WILLOW ROAD
SUITE 250
PLEASANTON, CA 94588
925-396-7700
925-396-7799 (FAX)

BKF
ENGINEERS / SURVEYORS / PLANNERS

STRIPING PLAN AND DETAILS
PORTER-KRESGE ROAD REPAIRS
90% CONSTRUCTION DOCUMENTS

UNIVERSITY OF CALIFORNIA
PHYSICAL PLANNING AND CONSTRUCTION
Santa Cruz, California

REVISIONS

DESIGNED SR
DRAWN SR
CHECKED JL

LOCATION
SANTA CRUZ, CA
SCALE
HORZ: 1"=20'

FILE NO.
8800-027

DATE 04/08/19
SHEET

C5.00
OF

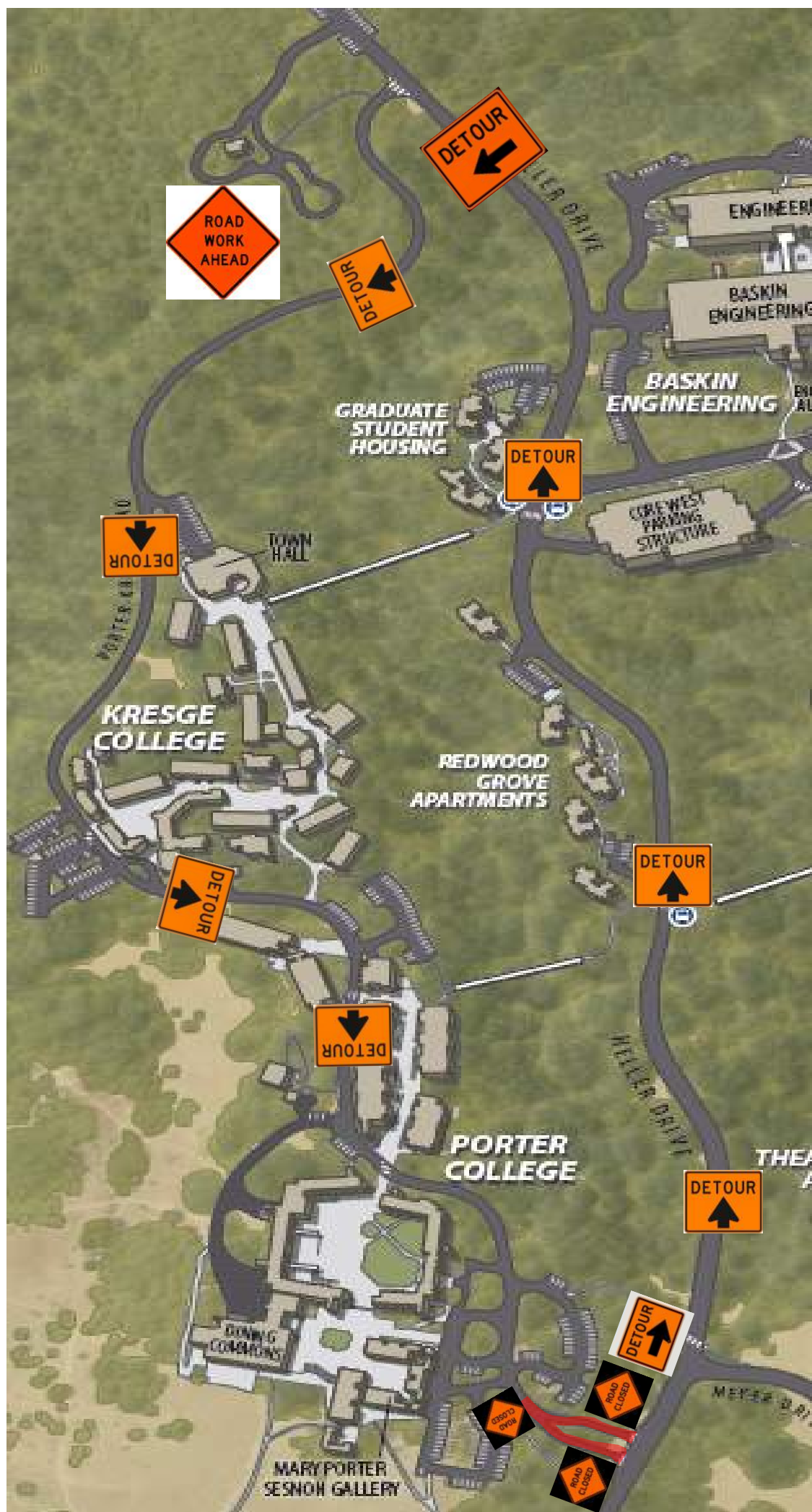

Grinding Operation:
6/27/2019

* Flagging As Needed
* All Grinding To Be Completed In One Day

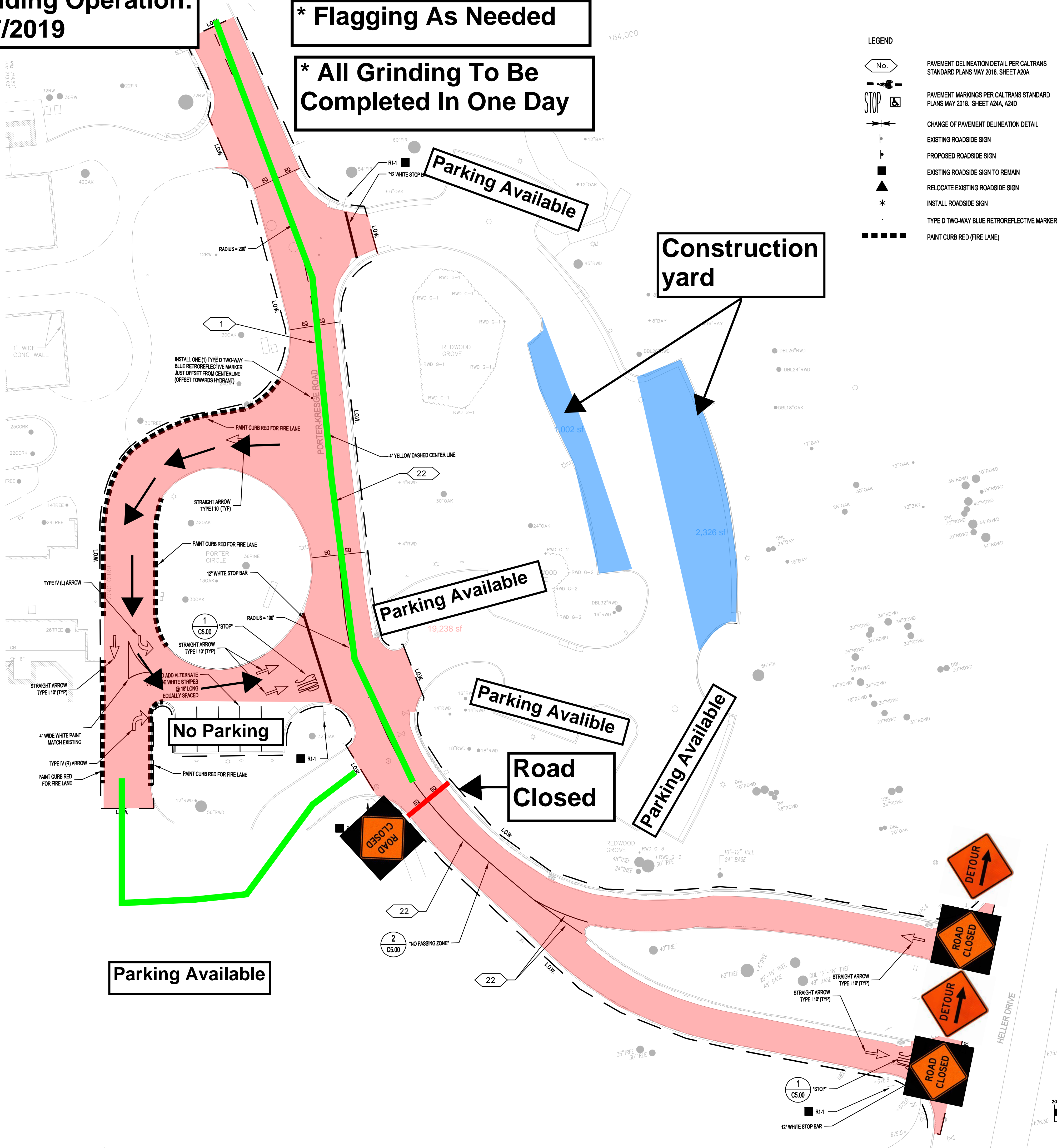

- LEGEND
- No. 1
 - STOP
 - CHANGE OF PAVEMENT DELINEATION DETAIL
 - EXISTING ROADSIDE SIGN
 - PROPOSED ROADSIDE SIGN
 - EXISTING ROADSIDE SIGN TO REMAIN
 - RELOCATE EXISTING ROADSIDE SIGN
 - INSTALL ROADSIDE SIGN
 - TYPE D TWO-WAY BLUE RETROREFLECTIVE MARKER
 - PAINT CURB RED (FIRE LANE)

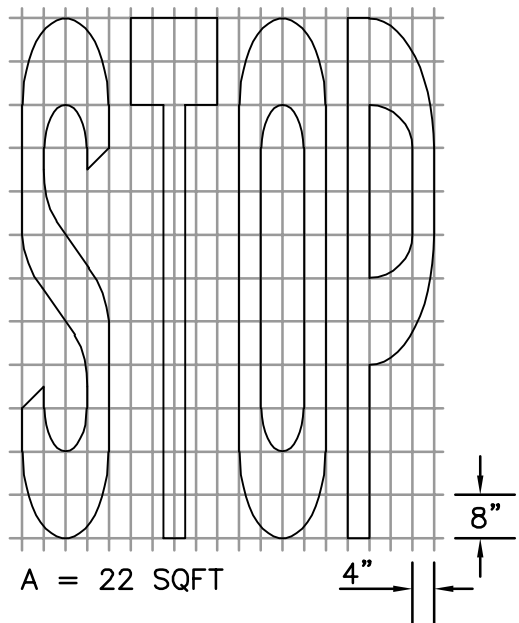

- NOTES:
- ALL PAVEMENT MARKINGS AND SIGNAGE SHALL BE IN ACCORDANCE WITH CALTRANS STANDARDS
 - IF A MESSAGE CONSISTS OF MORE THAN ONE WORD IT MUST READ "UP", I.E. THE FIRST WORD MUST BE NEAREST THE DRIVER.
 - MINOR VARIATIONS IN DIMENSIONS MAY BE ACCEPTED BY THE ENGINEER
 - ALL LETTERING TO BE THERMOPLASTIC PER SPEC SECTION 32 17 23 AND CALTRANS STANDARD SPECIFICATIONS

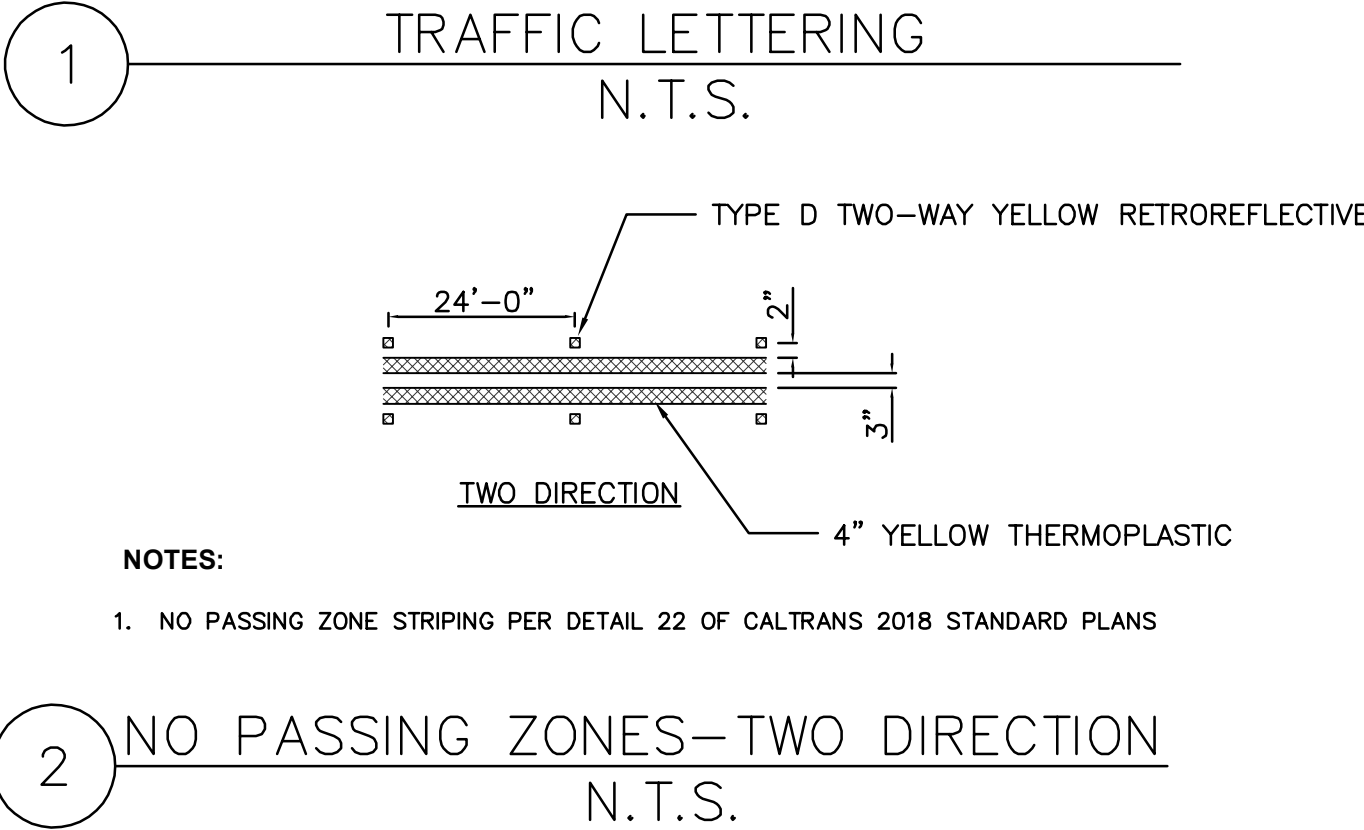

Legend:
Work Zone
: Two Way Traffic

4570 WILLOW ROAD
SUITE 250
PLEASANTON, CA 94588
925-396-7700
925-396-7799 (FAX)

BKF
ENGINEERS / SURVEYORS / PLANNERS

STRIPING PLAN AND DETAILS
PORTER-KRESGE ROAD REPAIRS
90% CONSTRUCTION DOCUMENTS

UNIVERSITY OF CALIFORNIA
PHYSICAL PLANNING AND CONSTRUCTION
Santa Cruz, California

REVISIONS

DESIGNED SR
DRAWN SR
CHECKED JL

LOCATION
SANTA CRUZ, CA
SCALE
HORZ: 1"=20'

FILE NO.
8800-027

DATE
04/08/19

SHEET

C5.00

OF

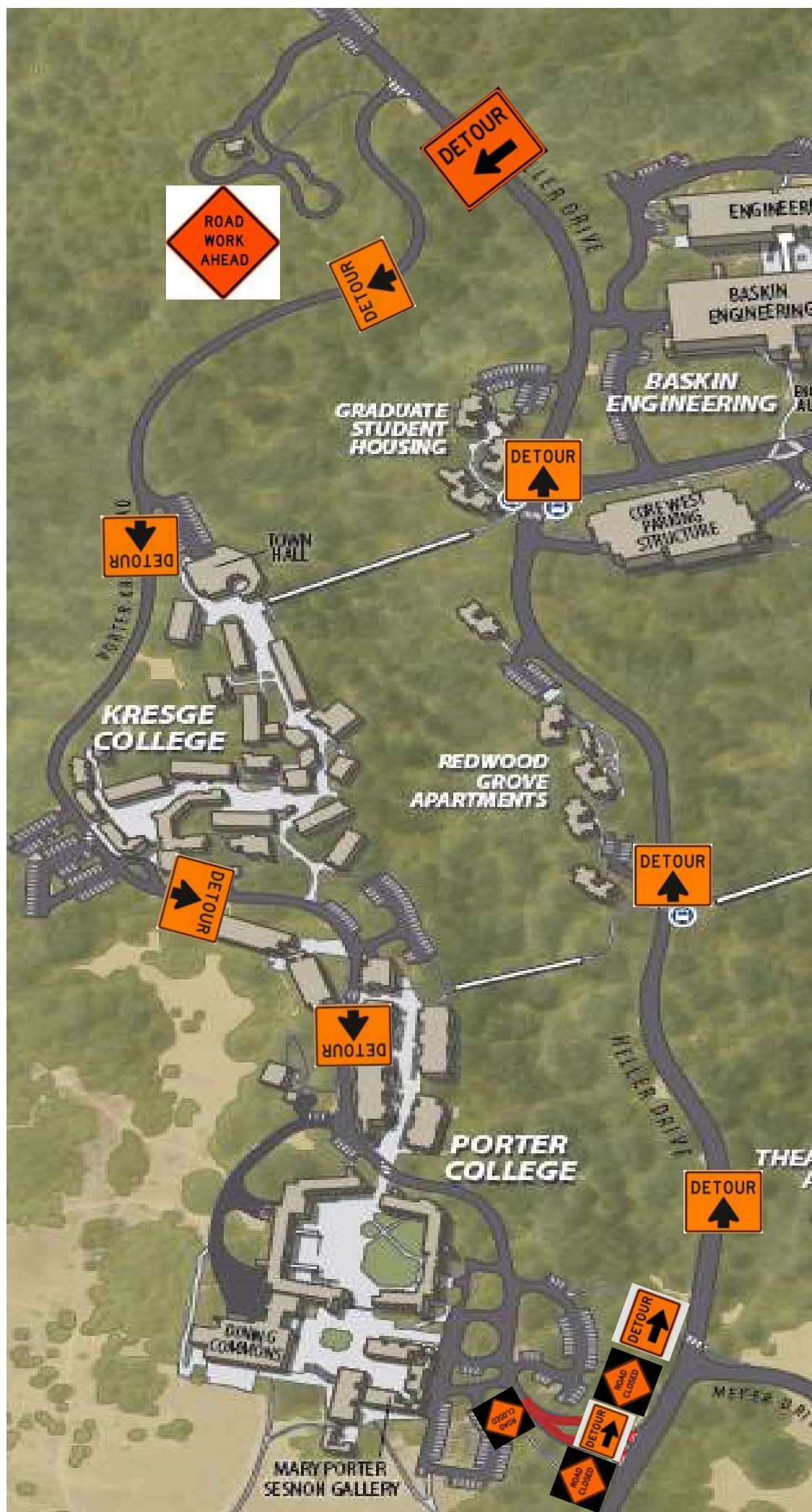

Dig Out Operation:
6/27/2019 & 7/3/2019

* Flagging As Needed

Will Complete Half Of Dig Out At A Time
In Order to Keep One Lane Open At All
Times; If Can Be Done Safely

Parking Available

Construction
yard

Parking Available

Road
Closed

Parking Available

No Parking

Parking Available

- LEGEND
- No. Pavement Delineation Detail Per Caltrans Standard Plans May 2018, Sheet A20A
 - STOP Pavement Markings Per Caltrans Standard Plans May 2018, Sheet A24A, A24D
 - Change of Pavement Delineation Detail
 - Existing Roadside Sign
 - Proposed Roadside Sign
 - Existing Roadside Sign to Remain
 - Relocate Existing Roadside Sign
 - Install Roadside Sign
 - Type D Two-Way Blue Retroreflective Marker
 - Paint Curb Red (Fire Lane)

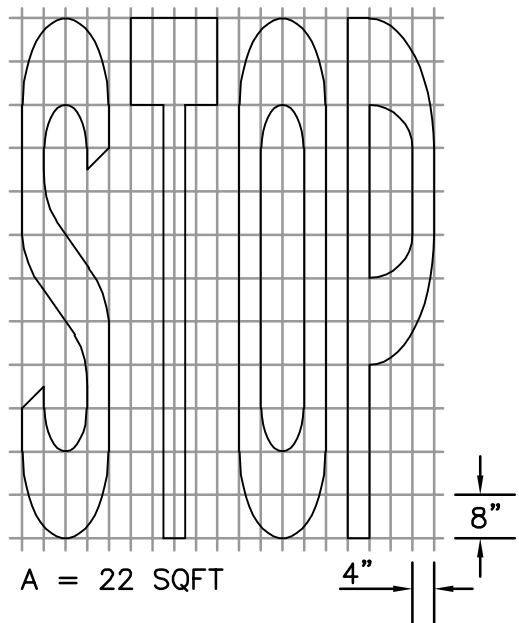

- NOTES:
- ALL PAVEMENT MARKINGS AND SIGNAGE SHALL BE IN ACCORDANCE WITH CALTRANS STANDARDS
 - IF A MESSAGE CONSISTS OF MORE THAN ONE WORD IT MUST READ "UP", I.E. THE FIRST WORD MUST BE NEAREST THE DRIVER.
 - MINOR VARIATIONS IN DIMENSIONS MAY BE ACCEPTED BY THE ENGINEER
 - ALL LETTERING TO BE THERMOPLASTIC PER SPEC SECTION 32 17 23 AND CALTRANS STANDARD SPECIFICATIONS

1 TRAFFIC LETTERING
N.T.S.

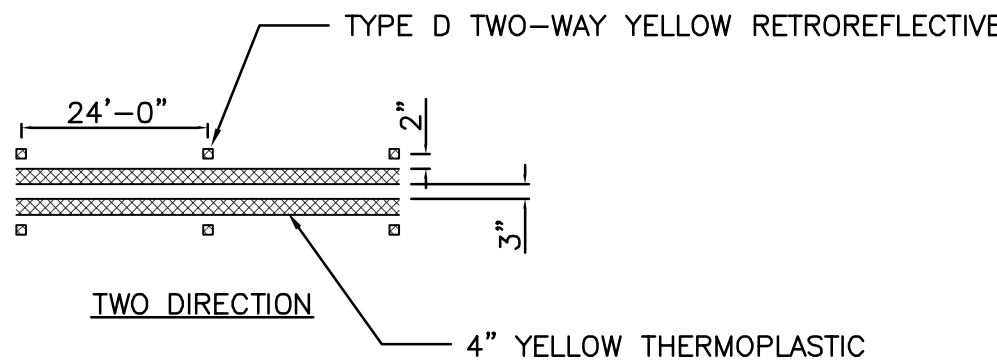

- NOTES:
- NO PASSING ZONE STRIPING PER DETAIL 22 OF CALTRANS 2018 STANDARD PLANS

2 NO PASSING ZONES-TWO DIRECTION
N.T.S.

Legend:
Work Zone

: Two Way Traffic

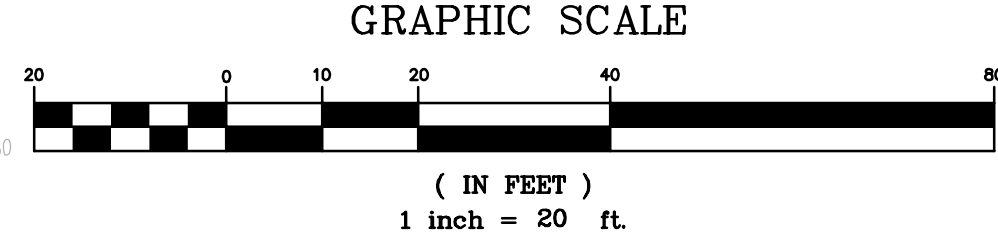

4670 WILLOW ROAD
SUITE 250
PLEASANTON, CA 94588
925-396-7700
925-396-7799 (FAX)

BKF
ENGINEERS / SURVEYORS / PLANNERS

STRIPING PLAN AND DETAILS
PORTER-KRESGE ROAD REPAIRS
90% CONSTRUCTION DOCUMENTS

UNIVERSITY OF CALIFORNIA
PHYSICAL PLANNING AND CONSTRUCTION
Santa Cruz, California

REVISIONS

DESIGNED	SR
DRAWN	SR
CHECKED	JL

LOCATION
SANTA CRUZ, CA
SCALE
HORZ: 1"=20'
FILE NO.
8800-027
DATE
04/08/19
SHEET
C5.00
OF

DATE: 04/08/19
BY: JLM
CHECKED: JL
PROJECT: PORTER-KRESGE ROAD REPAIRS
SHEET: C5.00

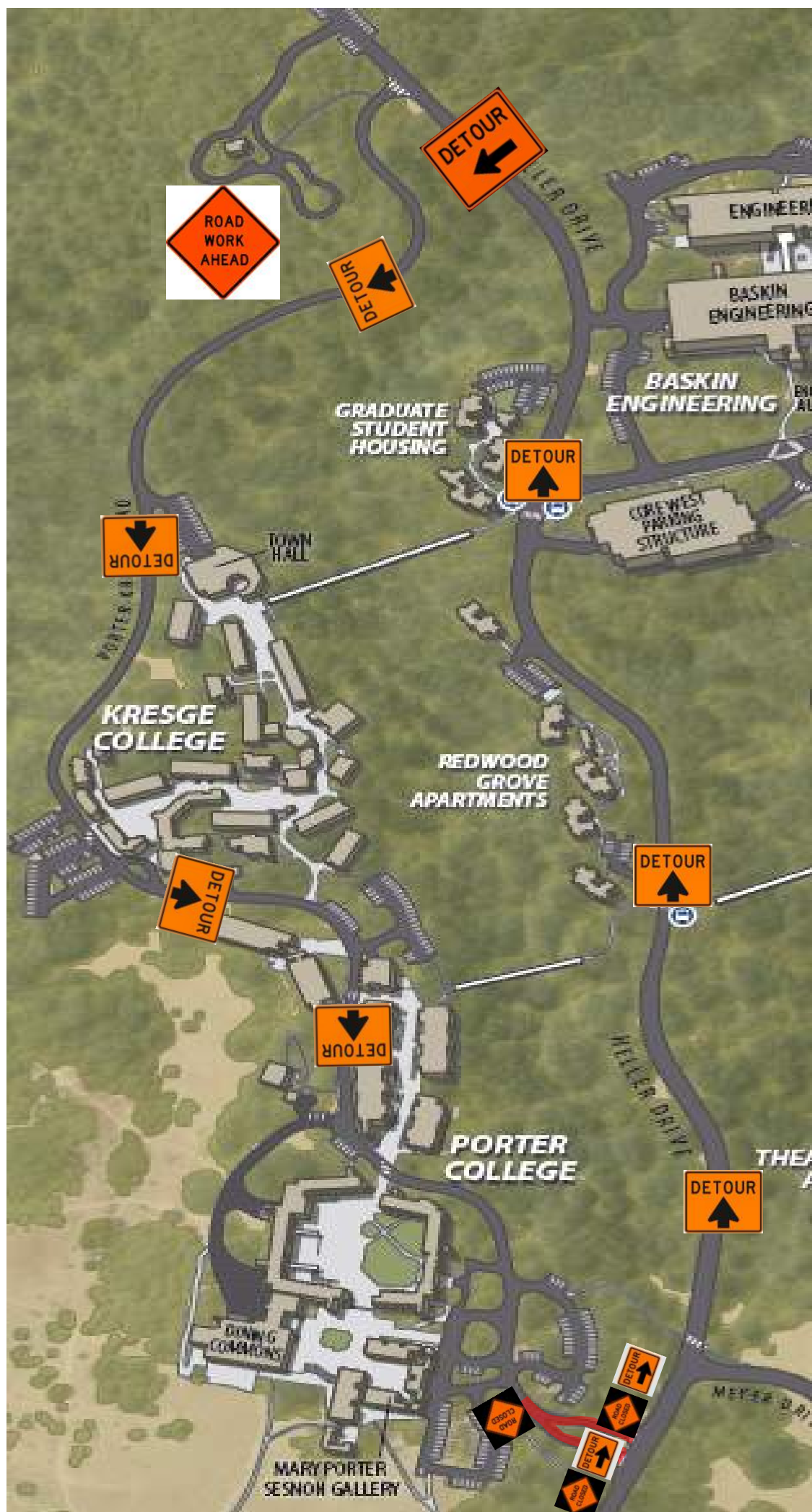

Paving Operation:
7/8/2019

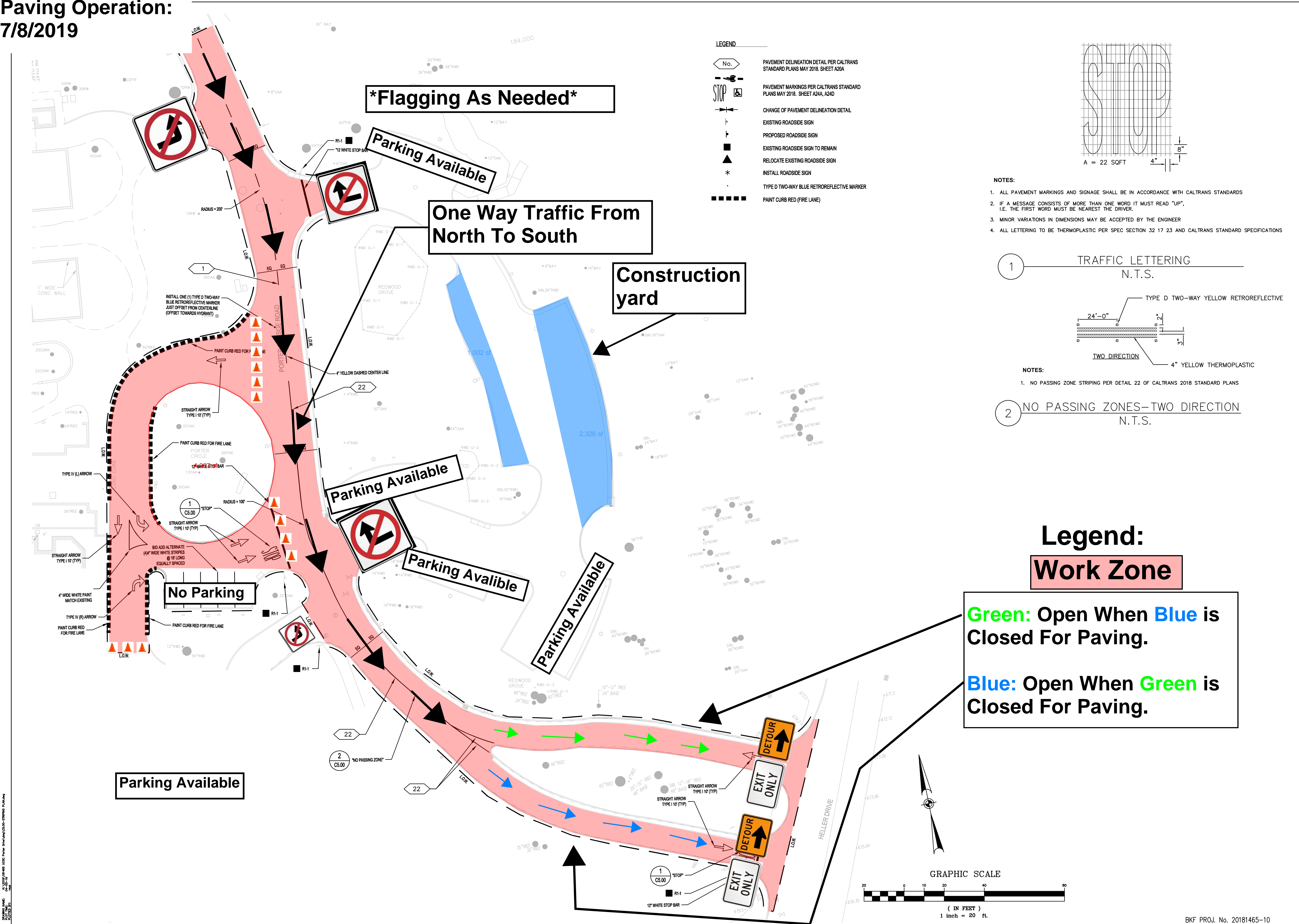

4570 WILLOW ROAD
SUITE 250
PLEASANTON, CA 94588
925-396-7700
925-396-7799 (FAX)

BKF
ENGINEERS / SURVEYORS / PLANNERS

STRIPING PLAN AND DETAILS
PORTER-KRESGE ROAD REPAIRS
90% CONSTRUCTION DOCUMENTS

UNIVERSITY OF CALIFORNIA
PHYSICAL PLANNING AND CONSTRUCTION
Santa Cruz Campus

REVISIONS

DESIGNED SR
DRAWN SR
CHECKED JL
LOCATION SANTA CRUZ, CA
SCALE HORZ: 1"=20'
FILE NO. 8800-027
DATE 04/08/19
SHEET
C5.00
OF

DATE: 04/08/19
BY: JLM
CHECKED: JL
DESIGNED: SR
DRAWN: SR
FILE NO: 8800-027
SHEET: C5.00

